

Spraying nozzles Type NC 3/4"

Flat spraying nozzle, used in systems of refrigeration, cleaning, and water curtain.

Set up with joint nut and screw.

Usage: In the process of washing, turning off and refrigeration. Cleaning, washing and refrigeration of gas.

For the request of **adapted products**, the following specifications are needed:

- Material
- Pulverization angle
- Kind of nozzle
- Ring
- Flow (l/min or l/h)
- Work pressure

The nominal flow is pulverizing water in normal conditions in an aerial way.

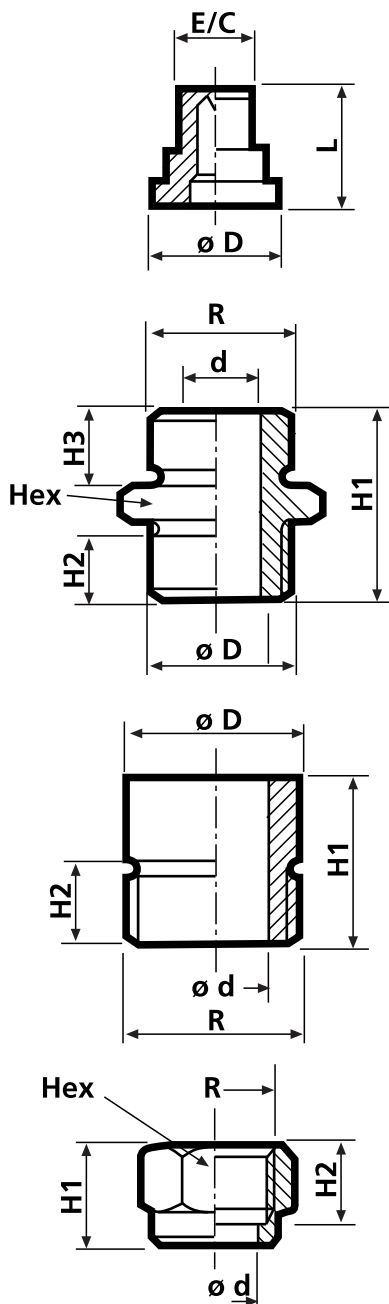

Nozzle measure in mm

ØD	L	E/C
24	10	20

Material: Brass or inox

Joint nut measure with double ring in mm

Hex	H1	H2	H3	d	R
32	35	14	14	19	3/4" G

Material: Brass or inox

Joint nut measure with single ring in mm

ØD	H1	H2	Ød	R
28	27	13	15	3/4" G

Material: Brass or inox

Screw measures in mm

R	Hex	H1	H2	Ø d
3/4" G	32	16	12	20,5

Material: Brass

Reference	Angle	Flow (l/min)		
		1,5 bar	3 bar	5 bar
08.30	30°	4,45	8	9,95
10.30	30°	5,65	10	12,50
12.30	30°	7,10	12	15,80
20.30	30°	11,30	20	25,30
30.30	30°	17,70	30	39,50

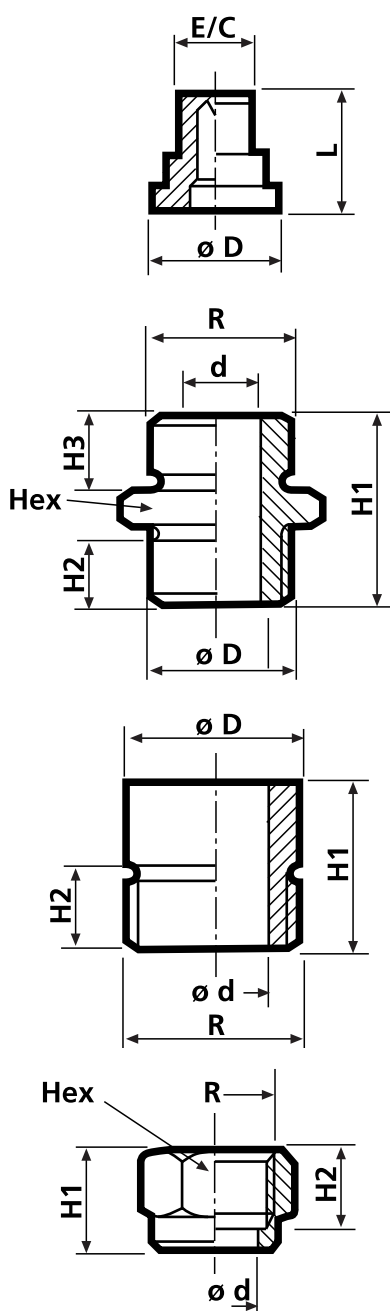
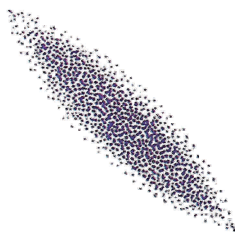

Reference	Angle	Flow (l/min)		
		1,5 bar	3 bar	5 bar
08.45	45°	4,45	8	9,95
10.45	45°	5,65	10	12,50
12.45	45°	7,10	12	15,80
20.45	45°	11,30	20	25,30
30.45	45°	17,70	30	39,50
08.60	60°	4,45	8	9,95
10.60	60°	5,65	10	12,50
12.60	60°	7,10	12	15,80
20.60	60°	11,30	20	25,30
30.60	60°	17,70	30	39,50
08.90	90°	4,45	8	9,95
10.90	90°	5,65	10	12,50
12.90	90°	7,10	12	15,80
20.90	90°	11,30	20	25,30
30.90	90°	17,70	30	39,50
08.120	120°	4,45	8	9,95
10.120	120°	5,65	10	12,50
12.120	120°	7,10	12	15,80
20.120	120°	11,30	20	25,30
30.120	120°	17,70	30	39,50

Nozzle measure in mm

ØD	L	E/C
24	10	20

Material: Brass or inox

Joint nut measure with double ring in mm

Hex	H1	H2	H3	d	R
32	35	14	14	19	3/4" G

Material: Brass or inox

Joint nut measure with single ring in mm

ØD	H1	H2	Ød	R
28	27	13	15	3/4" G

Material: Brass or inox

Screw measures in mm

R	Hex	H1	H2	Ø d
3/4" G	32	16	12	20,5

Material: Brass

The information included in this catalogue is merely informative. **TOBE** reserves the right to introduce modifications without prior notice. For any enquiry about any product that it is not included in this catalogue, please do not hesitate to contact with **TOBE**.